



Griffin Building

£550,000

Cosway are proud to offer for sale this modern two double bedroom, two bathroom (both ensuite) purpose built 2nd floor apartment situated in the stylish Millbrook Park development, conveniently located for Mill Hill East tube station, Virgin Active Gym & Waitrose Supermarket.

The property comprises a reception room open plan to quality fitted kitchen, two double bedrooms, tiled shower room and ensuite bathroom to main bedroom and Jack & Jill style family bathroom en-suite to 2nd bedroom. 2 Balconies.

Benefits include video entry phone, air filtration system, wood flooring, use of attractive communal gardens, resident's lift, balcony off reception room & separate balcony off bedroom one, allocated parking space in underground car park, use of secure bike shed, long lease & remainder of NHBC warranty.

Our client advises us that the property is Leasehold with approximately 245 years remaining on the lease with a Service charge of £3800 per annum. This includes car park service charge, ground rent and estate charge.

Viewing

Please contact our Mill Hill Office on 020 8959 0011 if you wish to arrange a viewing appointment for this property or require further information.

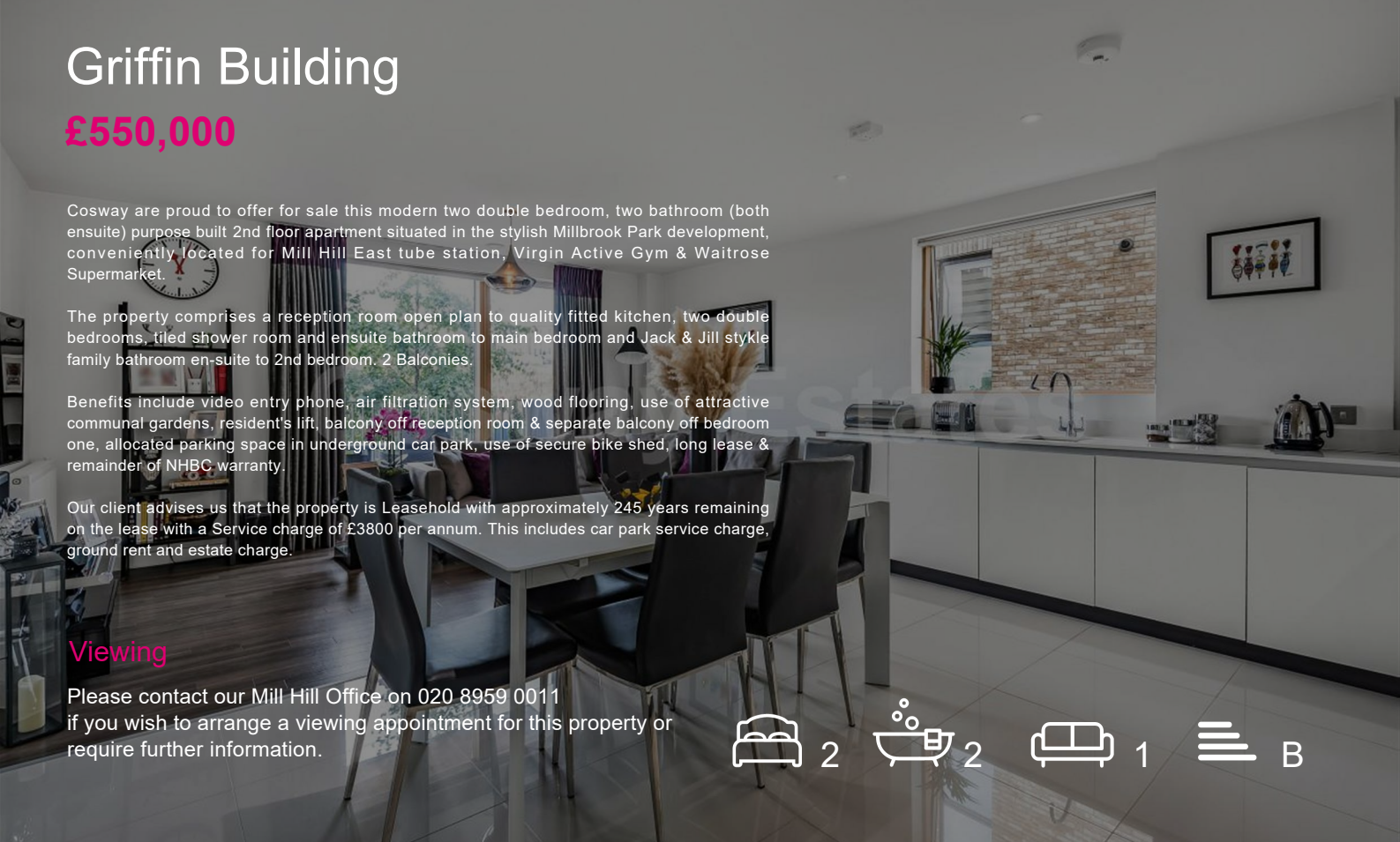

Floor Plan

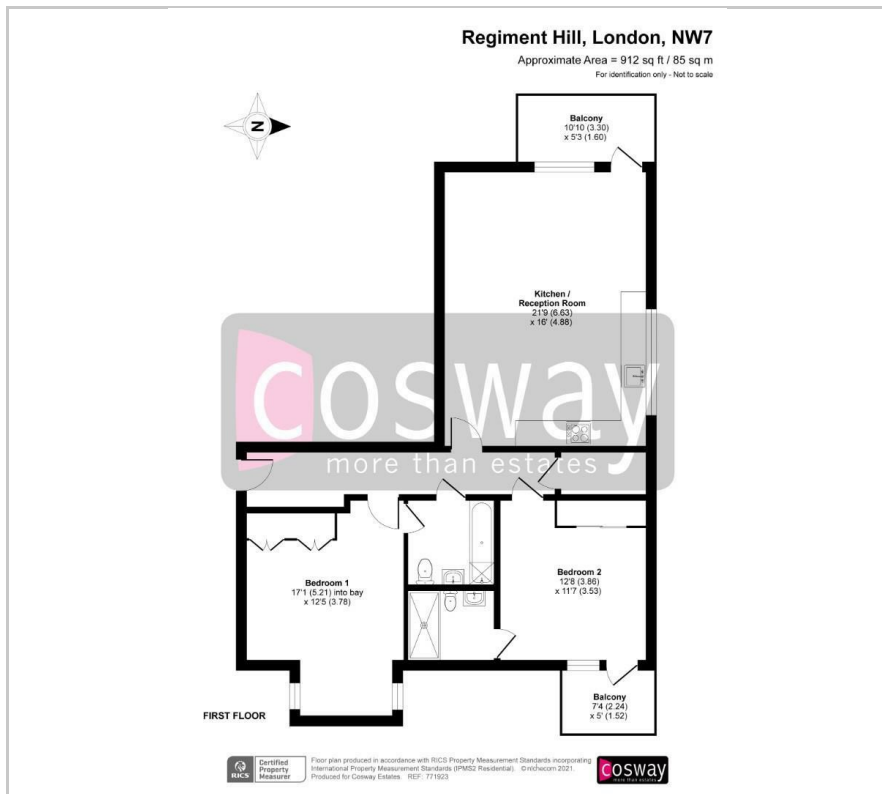

Area Map



Energy Efficiency Graph

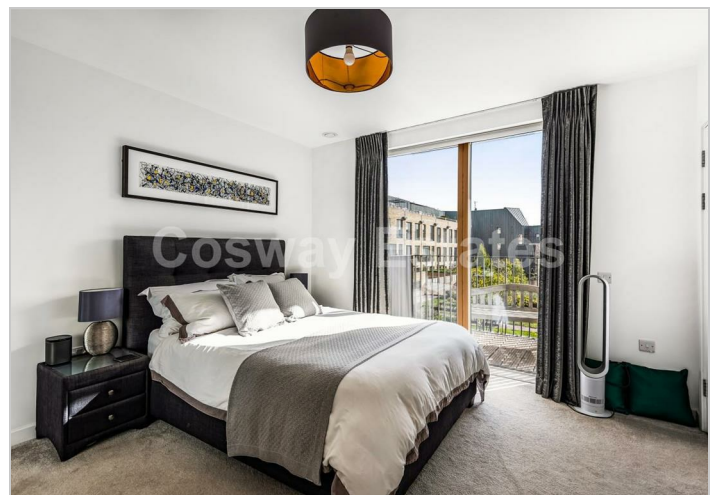
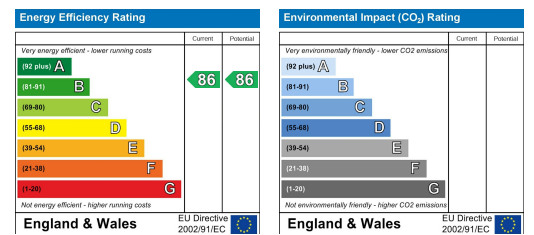

These particulars, whilst believed to be accurate are set out as a general outline only for guidance and do not constitute any part of an offer or contract. Intending purchasers should not rely on them as statements of representation of fact, but must satisfy themselves by inspection or otherwise as to their accuracy. No person in this firm's employment has the authority to make or give any representation or warranty in respect of the property.